

6070CB2 FLANGED ENDS 6073CB2 BUTT-WELD ENDS SWING CHECK CLASS 600 2"-12"

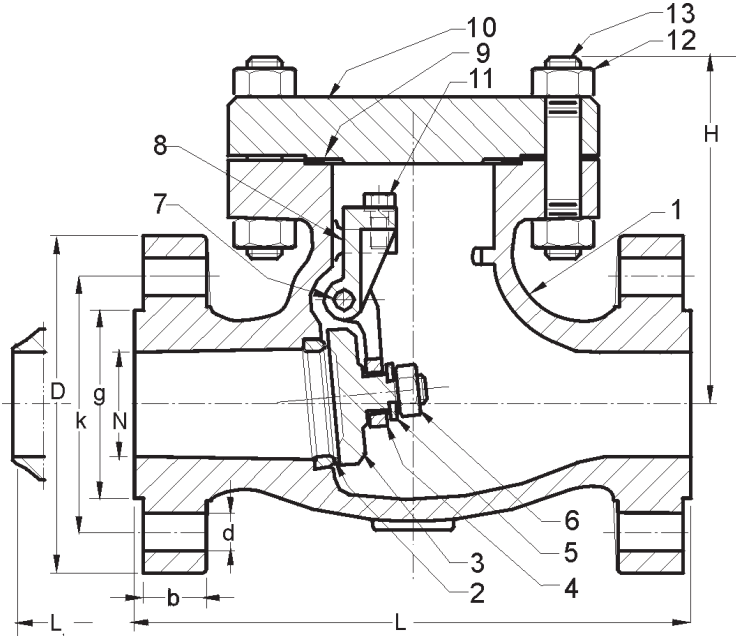

SPECIFICATIONS		
Design	API 600, ASME B 16.34	
P-T Rating	ASME B 16.34	
Connections	ASME B 16.5, 16.25	
Face to Face	ASME B 16.10	
Test & Inspection	API 598, RP 591	
MATERIAL LIST		
ITEM	PARTS NAME	MATERIALS
		Unless otherwise specified
1	Body	A216 Gr WCB
2	Seat Ring/Facing	A105 / Co-Cr-W Face or A216 Gr WCB / Co-Cr-W Face
3	Disc	2"-6" A182Gr F6aA182 Gr F6a 8"-12" A216 Gr WCB / 13% Cr Face
4	Disc Hinge	2"-6" A105 8"-12" A216 Gr WCB
5	Disc Washer	A276 Type 410
6	Disc Nut	A194 Gr6
7	Hinge Pin	A276 Type 410
8	Disc Support	A216 Gr WCB
9	Gasket	Spiral Wound S/S w/ Graphite
10	Cover	A105 A216 Gr WCB
11	Bolt	A276 Type 410
12	Cover Stud Bolt Nut	A194 Gr 2H
13	Cover Stud Bolt	A193 Gr B7

DIMENSIONS

Size NPS	Nominal Size Dia. N INCHES (mm)	Line Flange					Face to Face BW L=L1 INCHES (mm)	Height H INCHES (mm)	Line Flange Bolts		Weight Approx. lbs (kg)
		Dia. D INCHES (mm)	Thickness (min.) b INCHES (mm)	Bolt Circle Dia. k INCHES (mm)	Hole Dia. d INCHES (mm)	Raised Face Dia. g INCHES (mm)			Quantity	Size INCHES (metric)	
2	2.00	6.50	1.00	5.00	0.75	3.62	11.50	7.70	8	5/8	77
	50.8	165.1	25.4	127.0	19.1	91.9	292.1	195.6			
2 1/2	2.50	7.50	1.12	5.88	0.89	4.12	13.00	8.00	8	3/4	99
	63.5	190.5	28.4	149.4	22.6	104.6	330.2	203.2			
3	3.00	8.25	1.25	6.62	0.88	5.00	14.00	9.25	8	3/4	139
	76.2	209.6	31.8	168.1	22.4	127.0	355.6	235.0			
4	4.00	10.75	1.50	8.50	1.00	6.19	17.00	10.65	8	7/8	249
	101.6	273.1	38.1	215.9	25.4	157.2	431.8	270.5			
6	6.00	14.00	1.88	11.50	1.12	8.50	22.00	14.15	12	1	572
	152.4	355.6	47.8	292.1	28.4	215.9	558.8	359.4			
8	8.00	16.50	2.19	13.75	1.25	10.62	26.00	18.86	12	1 1/8	824
	203.2	419.1	55.6	349.3	31.8	269.7	660.4	479.0			
10	10.00	20.00	2.50	17.00	1.38	12.75	31.00	22.44	16	1 1/4	1346
	254.0	508.0	63.5	431.8	35.1	323.9	787.4	570.0			

Rev. 1

The information presented on this sheet is correct at the time of publication. Milwaukee Valve / Hammond Valve reserves the right to change design, and/or material specifications without notice. For the most current information access www.milwaukeevalve.com or www.hammondvalve.com

