

BA-100-TS

1/2" - 2"

**BRONZE BALL VALVE
TWO-PIECE, STANDARD-PORT DESIGN
THREADED x SWEAT CONNECTIONS**

MSS SP-110

MATERIALS LIST

ITEM	PART	MATERIALS	ASTM SPEC.
1	Body	Cast Bronze	B584
2	Tailpiece	Brass / Bronze (1" & up)	B16 / B584
3	Ball	Brass w/ Hard Chrome Plating	B16
4	Seat	RPTFE, 15% Glass Filled	
5	Stem	Brass	B16
6	Thrust Washer	RPTFE, 15% Glass Filled	
7	Packing	PTFE	
8	Packing Nut	Brass	B16
9	Handle	Steel w/ Zinc Plating	Commercial
10	Hand Grip	Vinyl	
11	Handle Nut	Steel w/ Zinc Plating	Commercial

Please consult factory for more information regarding steam applications.

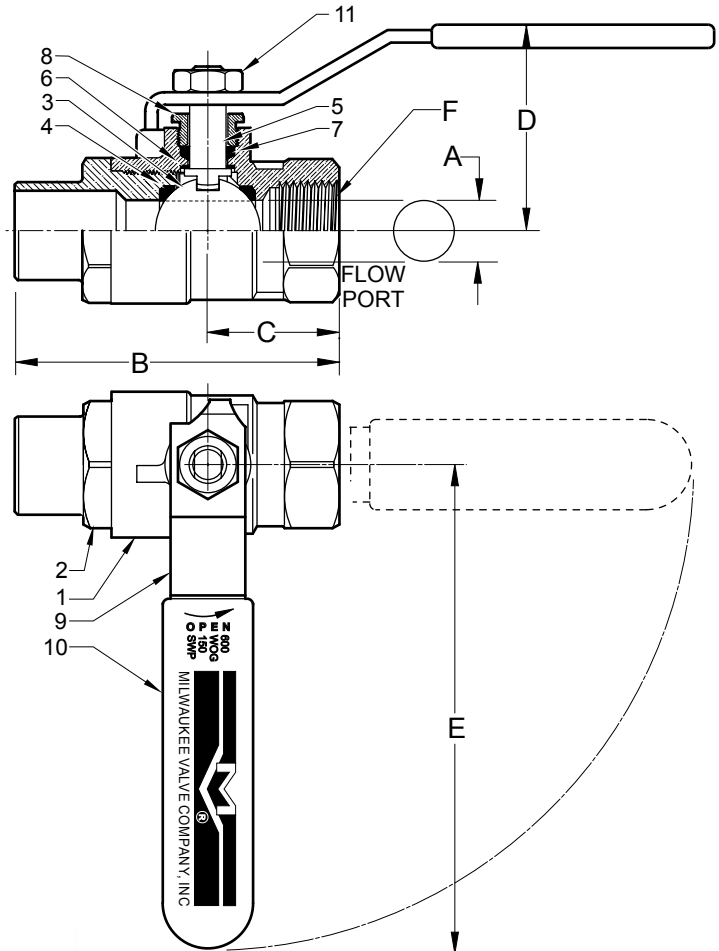
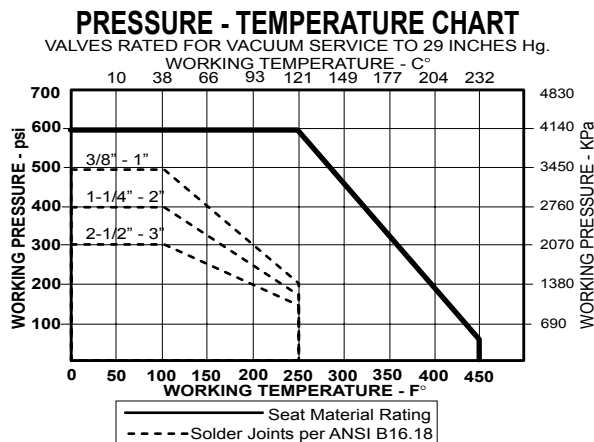

DIMENSIONS

	UNITS	1/2" DN15	3/4" DN20	1" DN25	1-1/4" DN32	1-1/2" DN40	2" DN50
A (DIA)	INCHES	0.50	0.76	0.88	1.06	1.31	1.56
	MM	12.8	19.3	22.4	26.9	33.3	39.6
B	INCHES	1.16	2.91	3.53	4.00	4.46	5.27
	MM	54.8	73.9	89.7	101.6	113.3	133.9
C	INCHES	1.07	1.30	1.58	1.74	1.97	2.15
	MM	27.1	33.0	40.0	44.0	50.0	55.0
D	INCHES	1.87	2.08	2.25	2.66	2.84	3.00
	MM	47.5	53.0	57.0	67.0	72.0	76.0
E	INCHES	3.19	4.84	4.84	6.35	6.35	7.20
	MM	81.0	123.0	123.0	161.0	161.0	183.0
F	THREAD SIZE	1/2" NPT	3/4" NPT	1" NPT	1-1/4" NPT	1-1/2" NPT	2" NPT
Cv		13	30	40	52	90	115

Note: DN (Diameter Nominal) = Metric equivalent size.

Rev. 11

The information presented on this sheet is correct at the time of publication. Milwaukee Valve reserves the right to change design, and/or material specifications without notice. For the Installation, Operation and Maintenance Manual (IOM) see the engineering section on our website. For the most current information access www.milwaukeevalve.com

