

BRONZE GLOBE SAMPLER VALVES

200 Lb. WOG • Threaded Ends

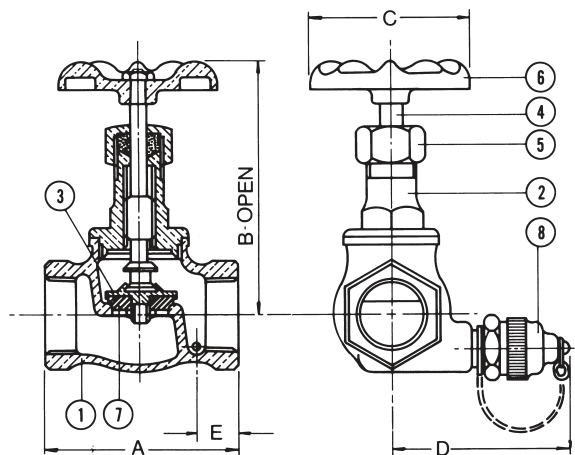

505-201

The bronze body globe sampler valves are designed for sampling or draining coolant from electrical apparatus. The 505-201 has a sampler boss tapped 3/8" NPT but does not include the M/V 84363-C sampling device. Body is bronze (ATSM B 62). The large port opening insures minimum flow resistance. Available in 1", 1 1/2", and 2" sizes. Rated at 200 lb. WOG.

505T-202

Same as 505-201 except with 84363-C sampling device.

505-203

Same as 505-201 except with 3/8" pipe plug.

DIMENSIONS - INCHES			
DIM.	VALVE SIZE		
	1	1 1/2	2
A	2 15/16	3 11/16	4 7/16
B	4 3/8	5 3/4	6 3/4
C	2 3/4	3 3/4	4 1/4
D	3 3/16	3 7/16	3 5/8
E	11/16	3/4	13/16

MATERIAL LIST		
NO.	DESCRIPTION	MATERIAL & SPECIFICATION
1	Body	Bronze
2	Bonnet	Bronze
3	Disc Holder	Brass
4	Stem	Brass
5	Stuff Nut	Brass
6	Handwheel	Bronze
7	Disc	Teflon
8	3/8" Sampler	84363

Rev. 2

